

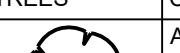



| PLANT SCHEDULE | | | | | | | | | |
|---|------|----------|---|-----------|---------|------------|-------------|----------|-----------------------|
| TREES | CODE | QTY | BOTANICAL / COMMON NAME | CONTAINER | CALIPER | HEIGHT | SPREAD | SPACING | NOTES |
|  | AMAR | 3 | AMELANCHIER ARBOREA SERVICEBERRY | B&B | 2 IN | 8 TO 10 FT | | AS SHOWN | STRONG CENTRAL LEADER |
|  | LITU | 2 | LIRIODENDRON TULIPIFERA TULIP POPLAR | B&B | 2 IN | 8 TO 10 FT | | AS SHOWN | STRONG CENTRAL LEADER |
| SHRUBS | CODE | QTY | BOTANICAL / COMMON NAME | CONTAINER | --- | HEIGHT | SPREAD | SPACING | NOTES |
|  | ABGR | 82 | ABELIA GRANDIFLORA GLOSSY ABELIA | 3 GAL | | 24 IN | 24 TO 30 IN | AS SHOWN | |
| SEED/SOD | CODE | QTY | BOTANICAL / COMMON NAME | CONTAINER | --- | HEIGHT | SPREAD | SPACING | NOTES |
|  | FESX | 3,840 SF | FESTUCA X COMMERCIAL FESCUE BLEND | SEED | | | | | |

CHAPTER 21 CITY TREE ORDINANCE CODE SUMMARY

FOR SINGLE FAMILY RESIDENTIAL

PERIMETER TREE REQUIREMENTS

TREES OF A MINIMUM TWO-INCH CALIPER MUST BE PLANTED WITHIN 20 FEET OF THE BACK OF THE CURB ON NEW STREETS, AND ANY EXISTING STREETS WITH LOT FRONTAGE, IN NEW SINGLE-FAMILY DEVELOPMENT. TREES MAY BE PLANTED BETWEEN THE SIDEWALK AND THE CURB IF A MINIMUM SIX-FOOT PLANTING STRIP IS PROVIDED. SPACING WILL BE AN AVERAGE OF 40 TO 50 FEET APART FOR LARGE MATURING SHADE TREES, AND 30 TO 40 FEET APART FOR SMALL MATURING SHADE TREES.

| | | |
|--|--|--|
| | WOODLAND BEAVER ROAD | N/A PRIVATE ROAD |
| | | |
| | ALBEMARLE ROAD (SOUTH SIDE) | PROPERTY FRONTAGE (LF) = 102' / 40 = 3 |
| | REQUIRED LARGE MATURING TREES | 3 LARGE MATURING TREES |
| | PROVIDED LARGE MATURING TREES | 3 LARGE MATURING TREES |

INTERNAL TREE REQUIREMENTS AND LANDSCAPE AREA

WHENEVER THE IMPERVIOUS COVER EXCEEDS 10,000 SQUARE FEET, A PLANTING AREA EQUAL TO TEN PERCENT OF THE TOTAL IMPERVIOUS SURFACE MUST BE PROVIDED FOR LANDSCAPE PURPOSES AND TREE PLANTING. INTERNAL TREE PLANTING IS REQUIRED AT THE RATE OF ONE LARGE MATURING SHADE TREE PER 10,000 SQUARE FEET OF IMPERVIOUS COVER OR FRACTION THEREOF. THIS PLANTING AREA MUST BE LOCATED ON PRIVATE PROPERTY AND IN URBAN ZONES SHALL BE IN ADDITION TO ANY PERIMETER PLANTING REQUIREMENTS.

CALCULATIONS

| NEW PROPOSED SITE | | | | |
|-------------------|--|--------------------------|------------------|--------------------------|
| | | AREA | 21,603 SF | |
| | | IMPERVIOUS AREA | 16,521 SF | |
| | | LANDSCAPE AREA REQUIRED | 1,545 SF | 10% OF TOTAL IMPERVIOUS |
| | | LANDSCAPE AREA PROVIDED | 6,025 SF | |
| | | LANDSCAPE TREES REQUIRED | 2 | 10,000/ TOTAL IMPERVIOUS |
| | | LANDSCAPE TREES PROVIDED | 2 | |

SCREENING REQUIREMENTS

ALL OFF-STREET PARKING FOR MORE THAN 10 AUTOMOTIVE VEHICLES OR LOADING AREA SERVING A RESIDENTIAL OR NONRESIDENTIAL USE SHALL BE SCREENED FROM ANY STREET RIGHT-OF-WAY OR ADJUTING LOT LOCATED IN ANY DISTRICT. SHRUBS USED IN ANY SCREENING OR LANDSCAPING MUST BE EVERGREEN, AT LEAST 2 TO 2½ FEET TALL WITH A MINIMUM SPREAD OF 2 FEET WHEN PLANTED AND NO FURTHER APART THAN 5 FEET. THEY MUST BE OF A VARIETY AND ADEQUATELY MAINTAINED SO THAT AN AVERAGE HEIGHT OF 5 TO 6 FEET COULD BE EXPECTED AS NORMAL GROWTH WITHIN 4 YEARS OF PLANTING.

TREE SAVE AREA NOTES

REFER TO THE CITY OF CHARLOTTE APPROVED PLANS LDC2013-00037
SHEET L100 FOR TREE SAVE REQUIREMENTS.



STEWART

101 N. TRYON ST., #1400
CHARLOTTE, NC 28202
T 704.334.7925

FIRM LICENSE #: C-1051
www.stewartinc.com
PROJECT #: C21049

Client

N3
1240 KIMBALL AVE
SOUTHLAKE TX, 76092
609.651.9327

FIRM LICENSE #: C-1051
www.stewartinc.com
PROJECT #: C21049

Consultants:

FRANZ ARCHITECT
4055 INTERNATIONAL PLAZA, SUITE 100
FORT WORTH TX, 76109
817.737.9922

Vicinity map

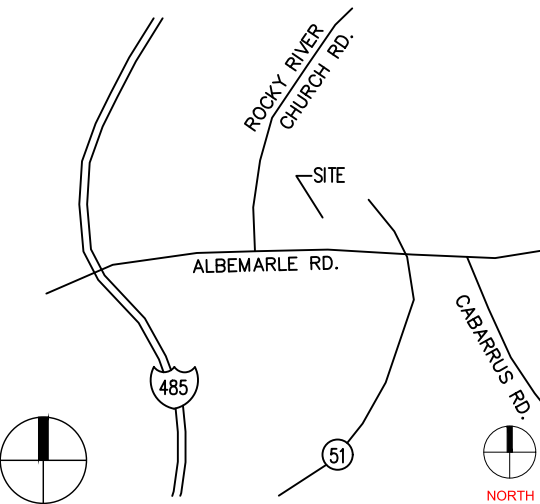

Seal:



09/10/2021

Scale

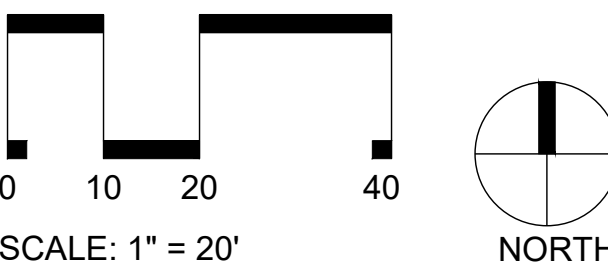

Project

BEAVER FARMS
LOT 5B

Issued for:

CONSTRUCTION DOCUMENTS

[illegible]

Title:

LANDSCAPE PLAN

Project number: C21049 Sheet #:

Project number: C21049 Sheet #:
 Issued Date: 09.10.2021
 Drawn by: JOT
 Approved by: JRB

L1.01

Client:

N3
1240 KIMBALL AVE
SOUTHLAKE TX, 76092
609.651.9327

Consultants:

FRANZ ARCHITECT
4055 INTERNATIONAL PLAZA, SUITE 100
FORT WORTH TX, 76109
817.737.9922

Nearby map

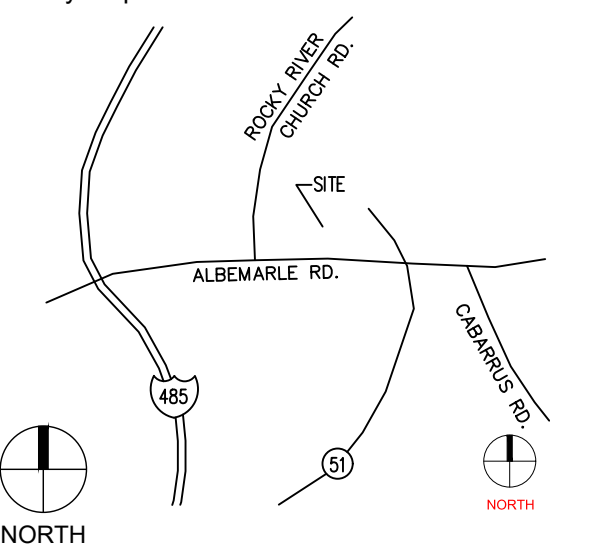

Seal:



09/10/2021

Project

BEAVER FARMS
LOT 5B

ssued for

CONSTRUCTION
DOCUMENTS

| No. | Date | Description |
|-----|------------|-----------------|
| 100 | 2023-01-01 | Initial deposit |
| 101 | 2023-01-05 | Withdrawal |
| 102 | 2023-01-10 | Deposit |
| 103 | 2023-01-15 | Withdrawal |
| 104 | 2023-01-20 | Deposit |
| 105 | 2023-01-25 | Withdrawal |
| 106 | 2023-01-30 | Deposit |
| 107 | 2023-02-05 | Withdrawal |
| 108 | 2023-02-10 | Deposit |
| 109 | 2023-02-15 | Withdrawal |
| 110 | 2023-02-20 | Deposit |
| 111 | 2023-02-25 | Withdrawal |
| 112 | 2023-03-01 | Deposit |
| 113 | 2023-03-05 | Withdrawal |
| 114 | 2023-03-10 | Deposit |
| 115 | 2023-03-15 | Withdrawal |
| 116 | 2023-03-20 | Deposit |
| 117 | 2023-03-25 | Withdrawal |
| 118 | 2023-03-30 | Deposit |
| 119 | 2023-04-05 | Withdrawal |
| 120 | 2023-04-10 | Deposit |
| 121 | 2023-04-15 | Withdrawal |
| 122 | 2023-04-20 | Deposit |
| 123 | 2023-04-25 | Withdrawal |
| 124 | 2023-05-01 | Deposit |
| 125 | 2023-05-05 | Withdrawal |
| 126 | 2023-05-10 | Deposit |
| 127 | 2023-05-15 | Withdrawal |
| 128 | 2023-05-20 | Deposit |
| 129 | 2023-05-25 | Withdrawal |
| 130 | 2023-06-01 | Deposit |
| 131 | 2023-06-05 | Withdrawal |
| 132 | 2023-06-10 | Deposit |
| 133 | 2023-06-15 | Withdrawal |
| 134 | 2023-06-20 | Deposit |
| 135 | 2023-06-25 | Withdrawal |
| 136 | 2023-07-01 | Deposit |
| 137 | 2023-07-05 | Withdrawal |
| 138 | 2023-07-10 | Deposit |
| 139 | 2023-07-15 | Withdrawal |
| 140 | 2023-07-20 | Deposit |
| 141 | 2023-07-25 | Withdrawal |
| 142 | 2023-08-01 | Deposit |
| 143 | 2023-08-05 | Withdrawal |
| 144 | 2023-08-10 | Deposit |
| 145 | 2023-08-15 | Withdrawal |
| 146 | 2023-08-20 | Deposit |
| 147 | 2023-08-25 | Withdrawal |
| 148 | 2023-09-01 | Deposit |
| 149 | 2023-09-05 | Withdrawal |
| 150 | 2023-09-10 | Deposit |
| 151 | 2023-09-15 | Withdrawal |
| 152 | 2023-09-20 | Deposit |
| 153 | 2023-09-25 | Withdrawal |
| 154 | 2023-10-01 | Deposit |
| 155 | 2023-10-05 | Withdrawal |
| 156 | 2023-10-10 | Deposit |
| 157 | 2023-10-15 | Withdrawal |
| 158 | 2023-10-20 | Deposit |
| 159 | 2023-10-25 | Withdrawal |
| 160 | 2023-11-01 | Deposit |
| 161 | 2023-11-05 | Withdrawal |
| 162 | 2023-11-10 | Deposit |
| 163 | 2023-11-15 | Withdrawal |
| 164 | 2023-11-20 | Deposit |
| 165 | 2023-11-25 | Withdrawal |
| 166 | 2023-12-01 | Deposit |
| 167 | 2023-12-05 | Withdrawal |
| 168 | 2023-12-10 | Deposit |
| 169 | 2023-12-15 | Withdrawal |
| 170 | 2023-12-20 | Deposit |
| 171 | 2023-12-25 | Withdrawal |
| 172 | 2024-01-01 | Deposit |
| 173 | 2024-01-05 | Withdrawal |
| 174 | 2024-01-10 | Deposit |
| 175 | 2024-01-15 | Withdrawal |
| 176 | 2024-01-20 | Deposit |
| 177 | 2024-01-25 | Withdrawal |
| 178 | 2024-02-01 | Deposit |
| 179 | 2024-02-05 | Withdrawal |
| 180 | 2024-02-10 | Deposit |
| 181 | 2024-02-15 | Withdrawal |
| 182 | 2024-02-20 | Deposit |
| 183 | 2024-02-25 | Withdrawal |
| 184 | 2024-03-01 | Deposit |
| 185 | 2024-03-05 | Withdrawal |
| 186 | 2024-03-10 | Deposit |
| 187 | 2024-03-15 | Withdrawal |
| 188 | 2024-03-20 | Deposit |
| 189 | 2024-03-25 | Withdrawal |
| 190 | 2024-04-01 | Deposit |
| 191 | 2024-04-05 | Withdrawal |
| 192 | 2024-04-10 | Deposit |
| 193 | 2024-04-15 | Withdrawal |
| 194 | 2024-04-20 | Deposit |
| 195 | 2024-04-25 | Withdrawal |
| 196 | 2024-05-01 | Deposit |
| 197 | 2024-05-05 | Withdrawal |
| 198 | 2024-05-10 | Deposit |
| 199 | 2024-05-15 | Withdrawal |
| 200 | 2024-05-20 | Deposit |

Title:

LANDSCAPE DETAILS

Project number: C21049 Sheet #:
Issued Date: 09.10.2021
Drawn by: JOT
Approved by: JRB

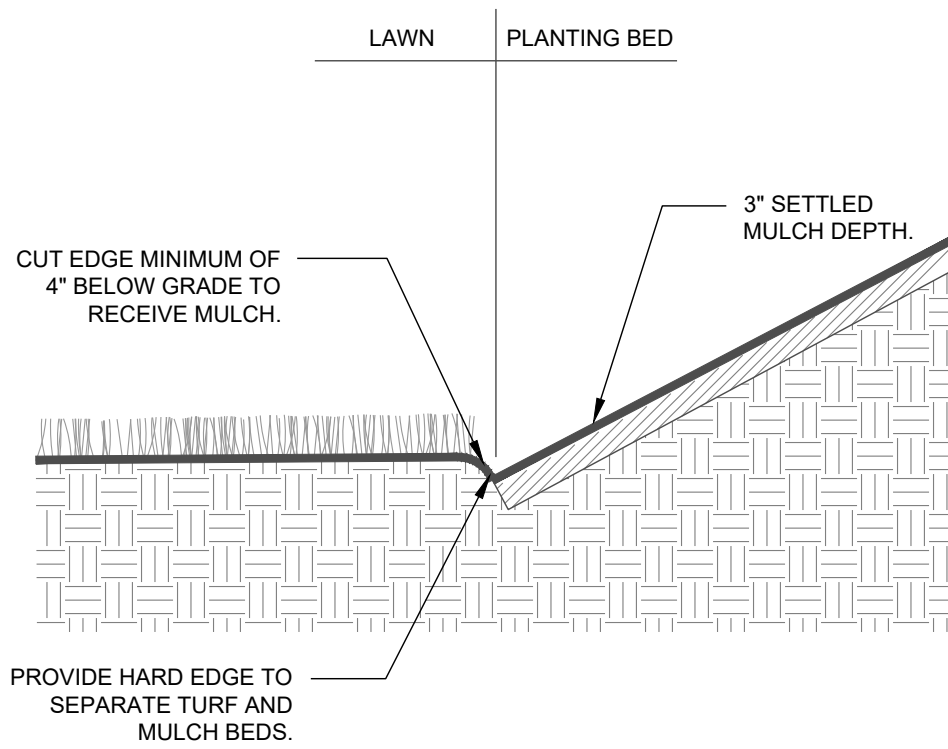

9 NOT USED

6 LAWN / PLANT BED TRENCH EDGING

NTS

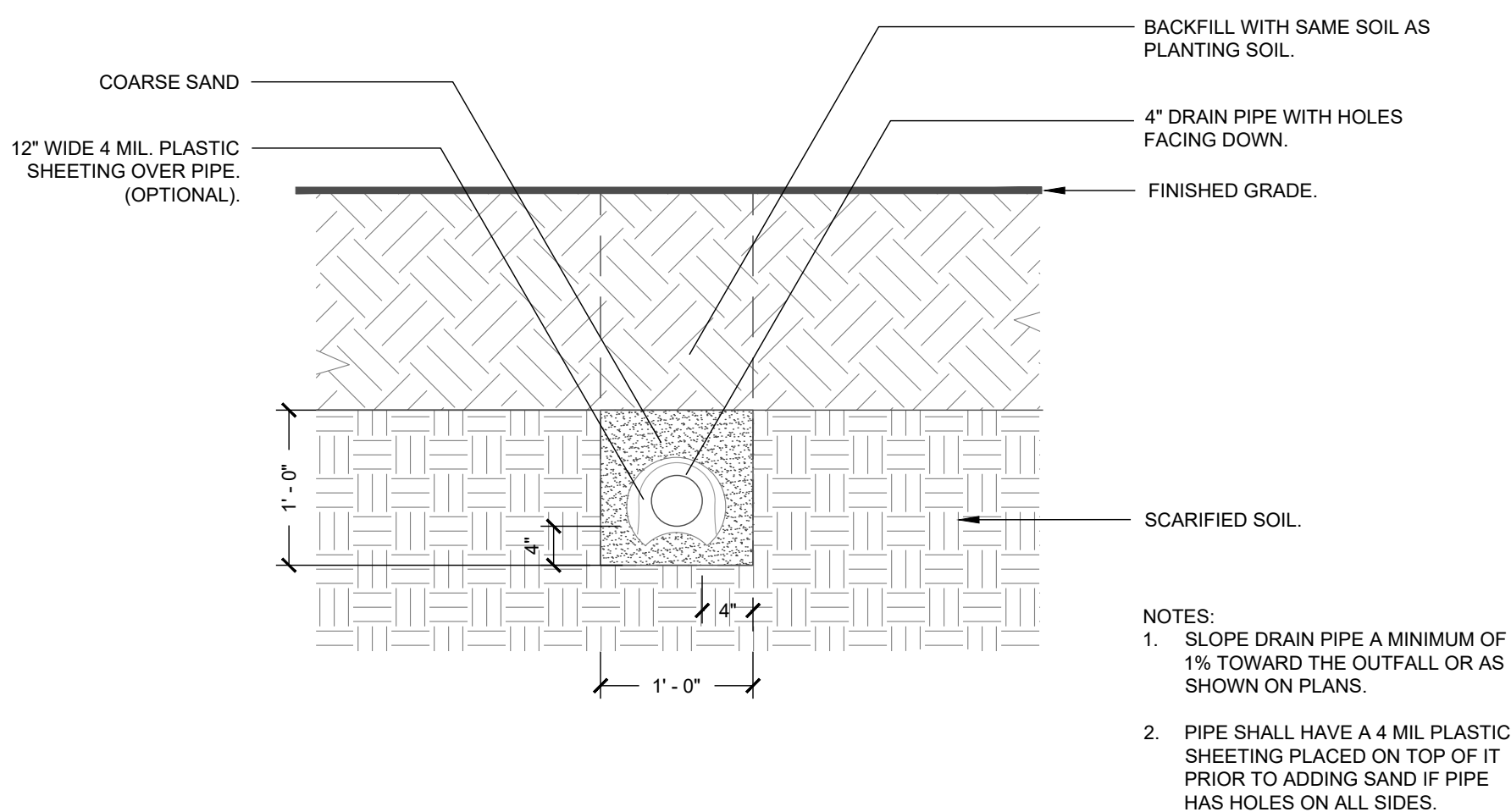

5 PLANTING PIT / BED DRAIN DETAIL

NTS

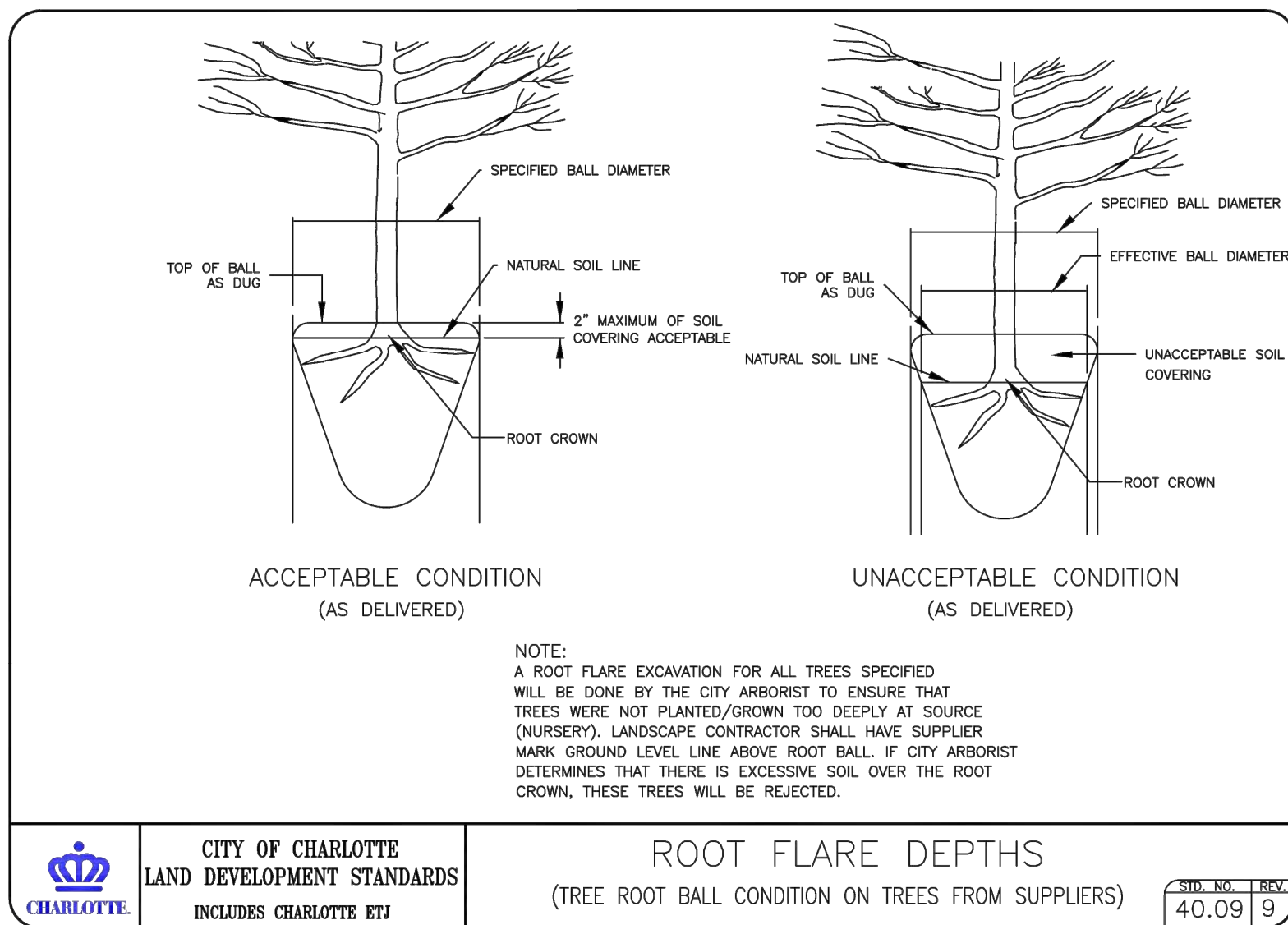

7 ROOT FLARE DEPTHS

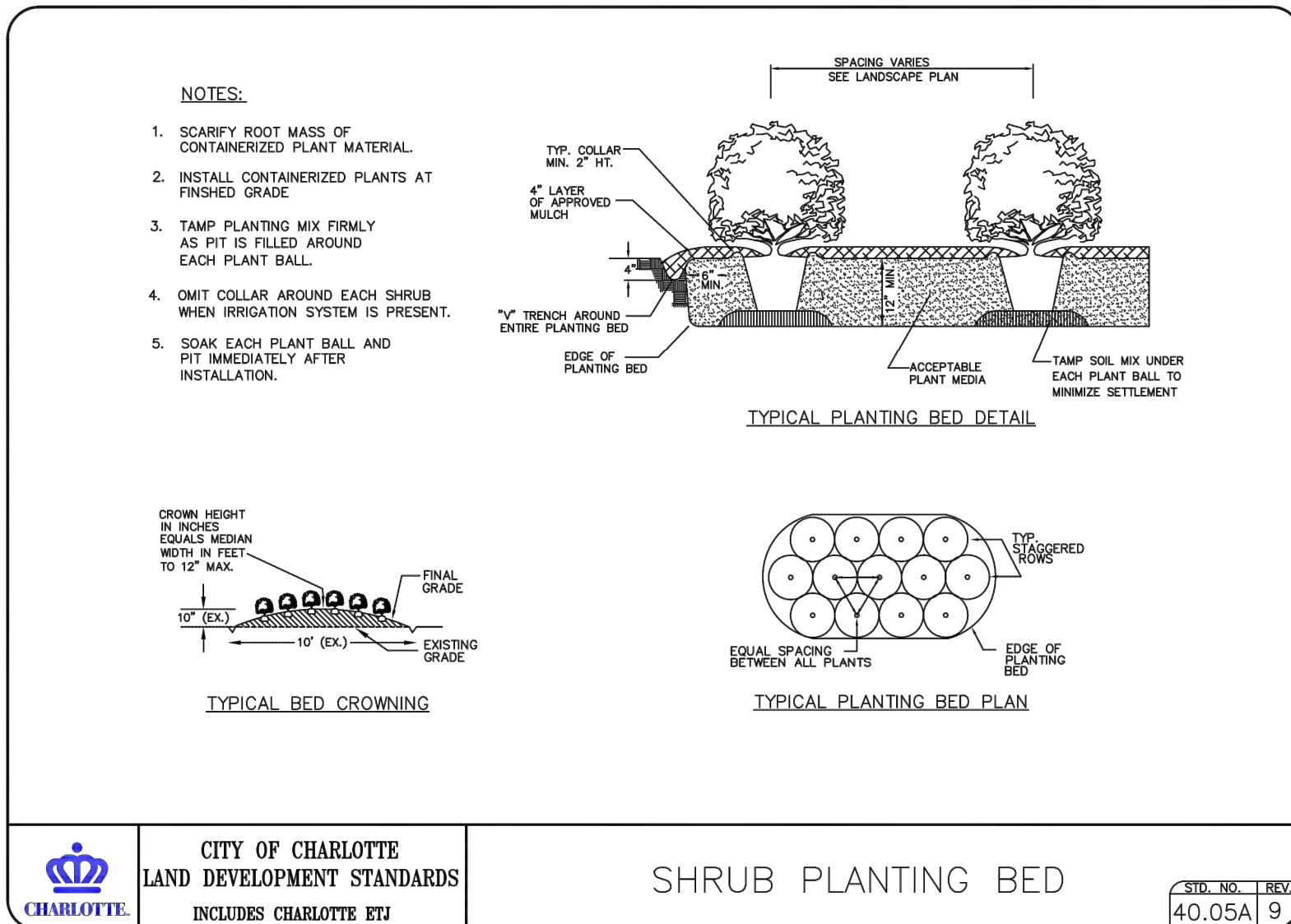

4 **SHRUB (TYPICAL)**
SECTION

NTS

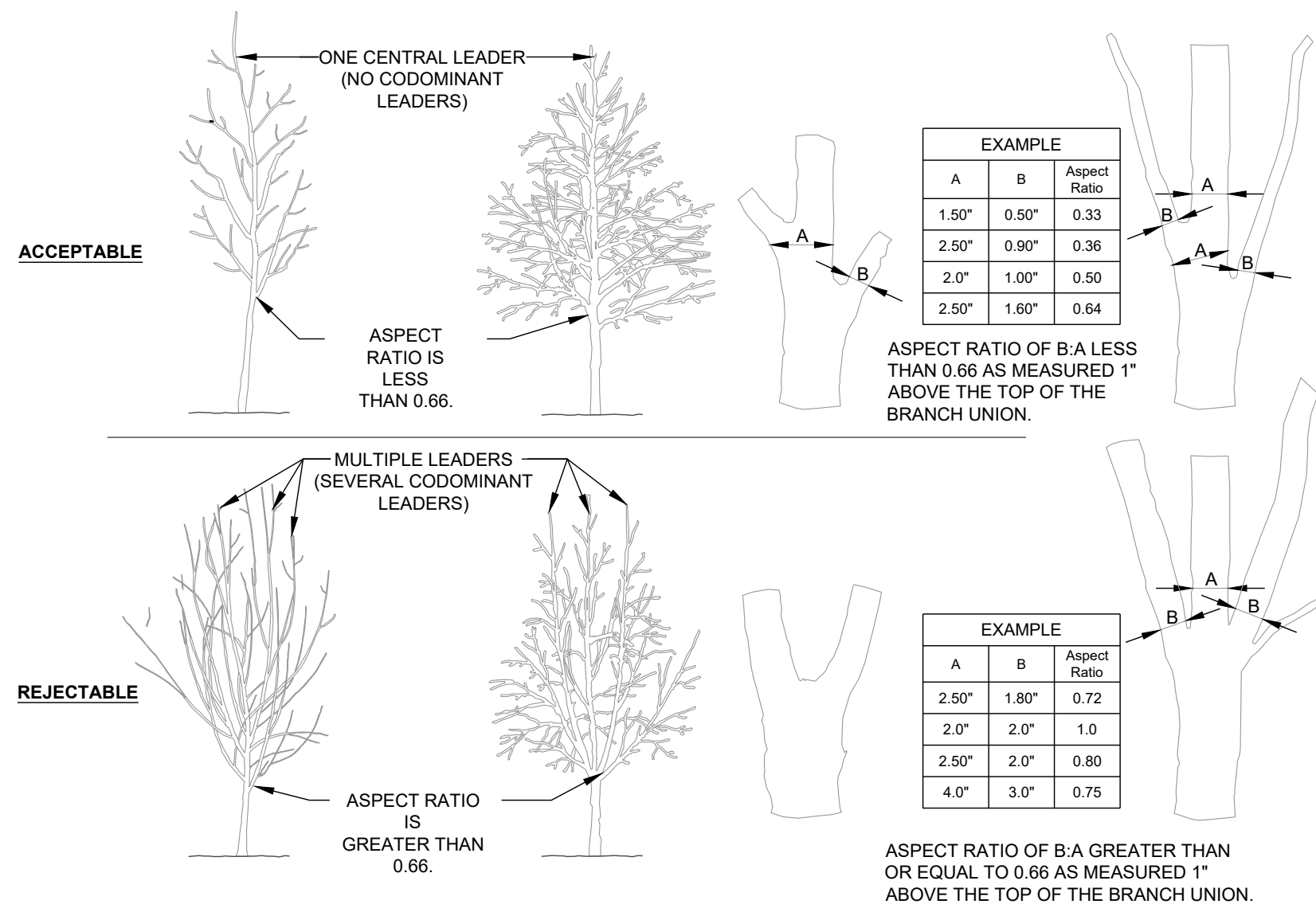

3 CROWN OBSERVATIONS - HIGH BRANCHED SECTION

NTS

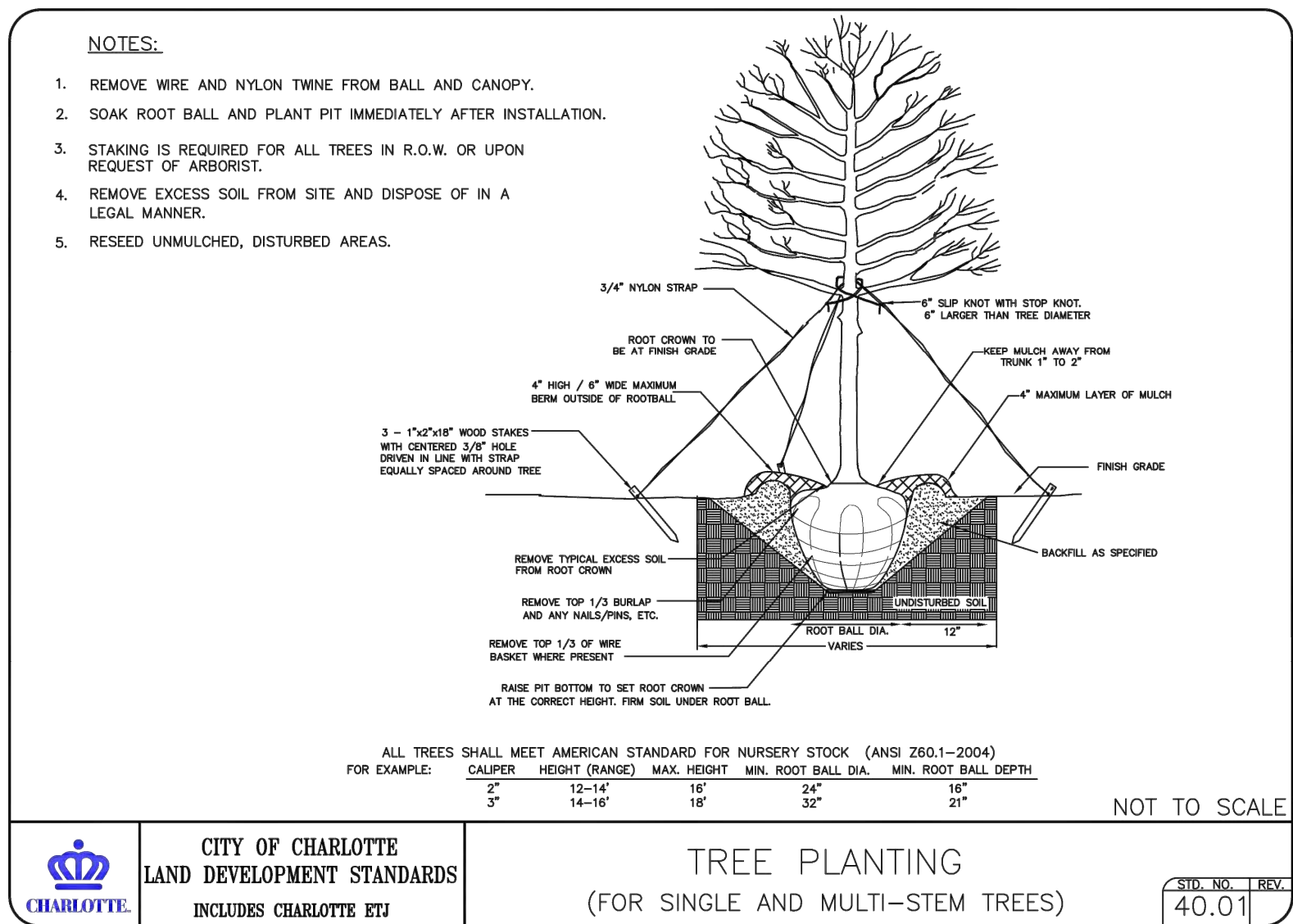

2 TREE (TYPICAL)
SECTION

NTS

PLANTING NOTES:

- | | | | |
|----|--|-----|--|
| 1. | DO NOT STAKE TREES EXCEPT WHERE SPECIFIED BY LANDSCAPE ARCHITECT. STAKING IS REQUIRED FOR TREES PLANTED ON SLOPES. | | SLOPING TO 2X THE ROOT BALL DIAMETER AT THE DEPTH OF THE ROOT BALL. |
| 2. | WHERE SEVERAL TREES WILL BE PLANTED CLOSE TOGETHER SUCH THAT THEY WILL LIKELY SHARE ROOT SPACE, TILL IN SOIL AMENDMENTS TO A DEPTH OF 4-6" OVER THE ENTIRE AREA. | 9. | AFTER PLANTING, ADD 3-4" OF WELL COMPOSTED LEAVES, RECYCLED YARD WASTE OR OTHER COMPOST AND TILL INTO TOP 6" OF PREPARED SOIL. ADD COMPOST AT 20-35% BY VOLUME TO BACKFILL. |
| 3. | FOR CONTAINER GROWN TREES, USE FINGERS OR SMALL HAND TOOLS TO PULL THE ROOTS OUT OF THE OUTER LAYER OF POTTING SOIL; THEN CUT OR PULL APART ANY ROOTS CIRCLING THE PERIMETER OF THE CONTAINER. | 10. | PERFORM PERCOLATION TEST FOR EACH TREE PIT TO CONFIRM THAT WATER DRAINS OUT OF THE SOIL. PROVIDE GRAVEL SUMP, FILTER FABRIC & VENT PIPE IF DRAINAGE DOES NOT OCCUR WITHIN 24 HOURS. INCLUDE ALL SUMPS IN BASE BID. SHOULD SUMPS NOT BE NECESSARY AFTER PERCOLATION TEST, PROVIDE CHANGE ORDER DEDUCT TO OWNER. |
| 4. | FOR FIELD GROWN TREES, CUT BURLAP, ROPE AND WIRE BASKET AWAY FROM TOP AND SIDES OF ROOT BALL. | 11. | IF PLANTING HILLS ARE DUG WITH A LARGE AUGER BREAKING DOWN THE SIDES WITH A SHOVEL, CAN ELIMINATE GLAZING AND CREATE THE PREFERRED SLOPING SIDE. |
| 5. | THOROUGHLY SOAK THE TREE ROOT BALL AND ADJACENT PREPARED SOIL SEVERAL TIMES DURING THE FIRST MONTH AFTER PLANTING AND REGULARLY THROUGHOUT THE FOLLOWING TWO SUMMERS. | 12. | TREES SHALL HAVE SINGLE LEADERS. TREES WITH 2 LEADERS WILL BE REJECTED. |
| 6. | THE PLANTING PROCESS IS SIMILAR FOR DECIDUOUS AND EVERGREEN TREES. | 13. | DO NOT PLACE MULCH IN CONTACT WITH TRUNK. |
| 7. | DO NOT WRAP TRUNK, MARK NORTH SIDE OF TREE IN THE NURSERY AND LOCATE TO THE NORTH IN THE FIELD. | 14. | PROVIDE GATOR BAGS FOR ALL TREES WHERE IRRIGATION IS NOT PROVIDED. |