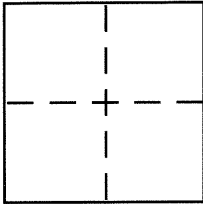

**CORNER RECORD**Document Number CR 9218City of HAYWARDCounty of ALAMEDA, CaliforniaBrief Legal Description SOUTHERLY LINE OF LOT 31, TRACT 553, PER BK. 8 OF MAPS, AT PG. 21**CORNER TYPE**

Government Corner ☐ Control ☐  
 Meander ☐ Property ☒  
 Rancho ☐ Other ☐  
 Date of Survey OCTOBER 28, 2016

**COORDINATES (Optional)**

N. \_\_\_\_\_  
 E. \_\_\_\_\_  
 Zone \_\_\_\_\_ NAD27 ☐ NAD83 ☐  
 NAD83 Epoch \_\_\_\_\_  
 Elev. \_\_\_\_\_  
 Vert. Datum: NGVD29 ☐ NAVD88 ☐  
 Meas. Units: Metric ☐ Imperial ☐

Corner – Left as found ☐ Found and tagged ☐ Established ☒ Reestablished ☐ Rebuilt ☐

Identification and type of corner found: Evidence used to identify or procedure used to establish or reestablish the corner:

**FOUND: STANDARD PIN MONUMENTS INSIDE MONUMENT WELLS IN VICTORY DRIVE, AND AT THE INTERSECTION WITH MARIN AVENUE, PER TRACT 553 (BK. 8 MAPS, PG. 21)**

**SEE SKETCH ON PAGE 2 OF 2**

A description of the physical condition of the monument as found and as set or reset: \_\_\_\_\_

**SET: NAIL & 3/4" BRASS TAG "PLS 7393" IN CONCRETE**

**SEE SKETCH ON PAGE 2 OF 2**

**SURVEYOR'S STATEMENT**

This Corner Record was prepared by me or under my direction in conformance with the Land Surveyor's Act on NOVEMBER 04 2016

Signed K. Nofield P.L.S. or R.C.E. No. PLS 7393

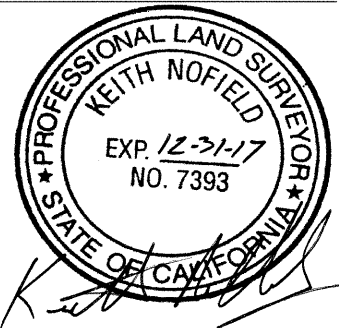
**COUNTY SURVEYOR'S STATEMENT**

This Corner Record was received 4 NOVEMBER, 2016

and examined and filed 2 DECEMBER, 2016

Signed Michael Rubner P.L.S. or R.C.E. No. 6843

Title COUNTY SURVEYOR

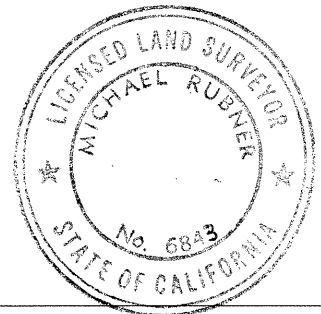

County Surveyor's Comment \_\_\_\_\_

VICTORY DRIVE  
(50' WIDE)

