

# CORNER RECORD

City of Oakland

Brief Legal Description City of Oakland Monument.

BK 50 PG 43

Document Number CR 5448

County of Alameda, California

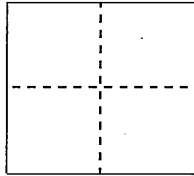

## CORNER TYPE

Government Corner ☐ Control ☐  
Meander ☐ Property ☐  
Rancho ☐ Other ☒

Date of Survey April 3, 2013

## COORDINATES (Optional)

N. \_\_\_\_\_  
E. \_\_\_\_\_  
Zone \_\_\_\_\_ NAD27 ☐ NAD83 ☐  
NAD83 Epoch \_\_\_\_\_  
Elev. \_\_\_\_\_  
Vert. Datum: NGVD29 ☐ NAVD88 ☐  
Meas. Units: Metric ☐ Imperial ☐

Corner - Left as found ☒ Found and tagged ☐ Established ☐ Reestablished ☐ Rebuilt ☐

Identification and type of corner found: Evidence used to identify or procedure used to establish or reestablish the corner:

In compliance with Section 8771 of the Professional Land Surveyors' Act, this corner record is being filed to ESTABLISH the position of an existing monument PRIOR to street or highway construction.

A description of the physical condition of the monument as found and as set or reset:

See sketch on back

## SURVEYOR'S STATEMENT

This Corner Record was prepared by me or under my direction in conformance with the Professional Land Surveyor's Act on June 4, 2013

Signed William Douglas Crume P.L.S. or R.C.E. No. LS 7059

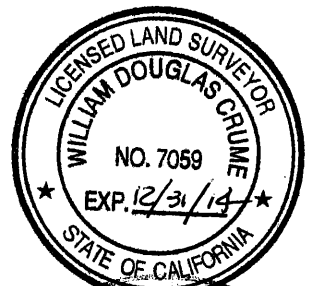

## COUNTY SURVEYOR'S STATEMENT

This Corner Record was received \_\_\_\_\_  
and examined and filed \_\_\_\_\_

Signed Russell R. Penland P.L.S. or R.C.E. No. 5726

Title County Surveyor

County Surveyor's Comment: \_\_\_\_\_



HX5786

