

I:\Projects\NTR21002\04-Production\Engineering\Construction Documents\Current Drawings\NTR21002-ESPC.dwg, 12/14/2021 2:48:34 PM, Lauren Micallef

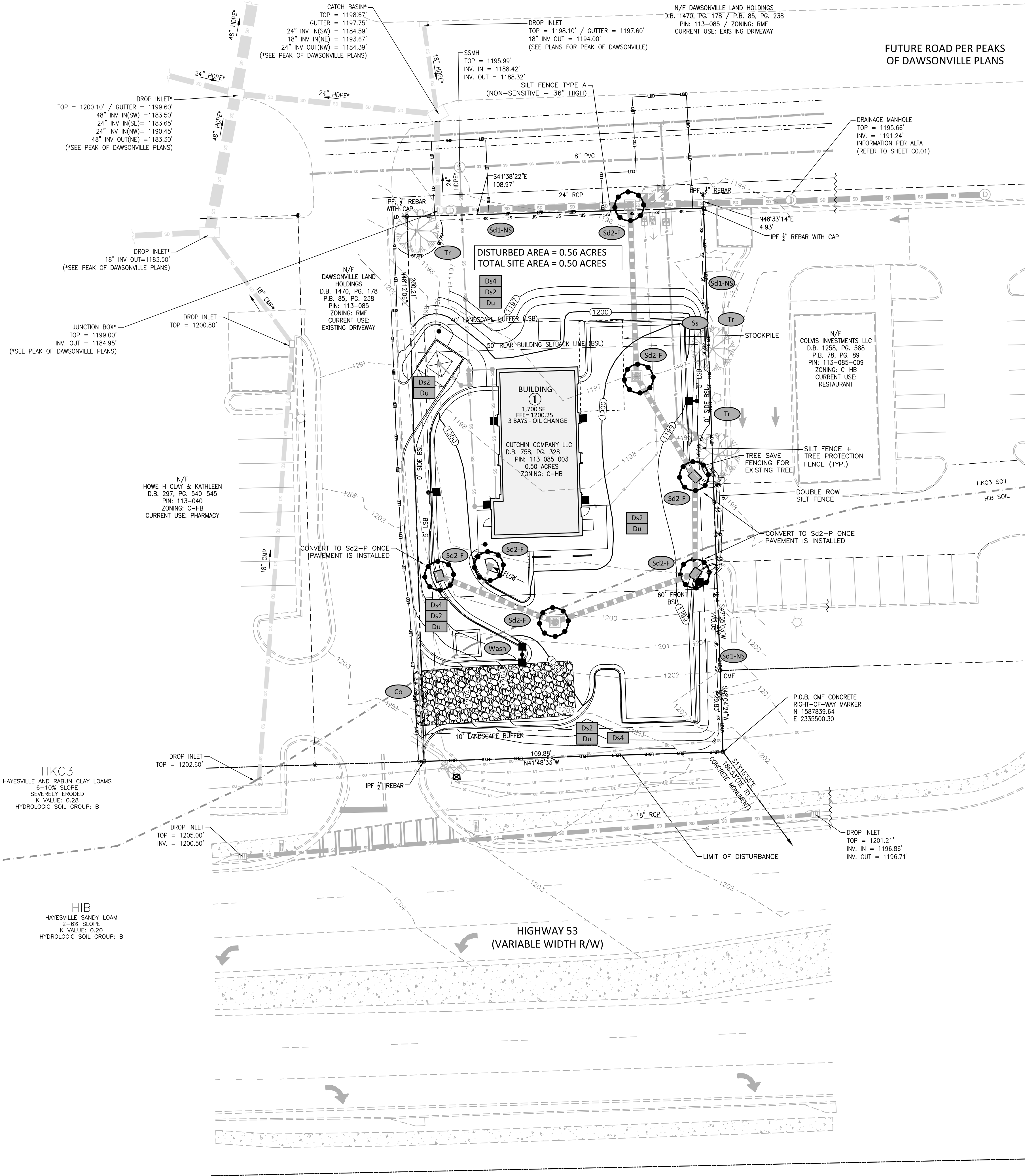

DAWSON COUNTRY EROSION & SEDIMENTATION NOTES:

1. THE ESCAPE OF SEDIMENT FROM THE SITE SHALL BE PREVENTED BY THE INSTALLATION OF EROSION AND SEDIMENT CONTROL MEASURES AND PRACTICES PRIOR TO, OR CONCURRENT WITH, LAND DISTURBING ACTIVITIES.
2. EROSION CONTROL MEASURES WILL BE MAINTAINED AT ALL TIMES. IF FULL IMPLEMENTATION OF THE APPROVED PLANS DOES NOT PROVIDE FOR EFFECTIVE EROSION CONTROL, ADDITIONAL EROSION AND SEDIMENT CONTROL MEASURES SHALL BE IMPLEMENTED TO CONTROL OR TREAT THE SEDIMENT SOURCE.
3. ADDITIONAL EROSION AND SEDIMENT CONTROL MEASURES AND PRACTICES WILL BE INSTALLED IF DEEMED NECESSARY BY THE ON-SITE INSPECTOR. ANY DISTURBED AREA LEFT EXPOSED FOR A PERIOD GREATER THAN 14 DAYS SHALL BE STABILIZED WITH MULCH OR TEMPORARY SEEDING.
4. EROSION AND SEDIMENT CONTROL MEASURES AND PRACTICES TO BE INSPECTED DAILY.
5. CUT AND FILL SLOPES SHALL NOT EXCEED 3H:1V ON RESIDENTIAL PROJECTS AND LOTS, AND LOTS SHALL NOT EXCEED 2H:1V ON ALL OTHER PROJECTS. WEEKLY EROSION AND SEDIMENT CONTROL REPORTS SHALL BE SUBMITTED TO THE DEVELOPMENT DEPARTMENT STARTING WITH THE ISSUANCE OF THE DEVELOPMENT PERMIT AND ENDING WHEN THE PROJECT IS RELEASED BY THE INSPECTOR.
6. "I CERTIFY THAT THE PERMITTEE'S EROSION, SEDIMENTATION AND POLLUTION CONTROL PLAN PROVIDES FOR AN APPROPRIATE AND COMPREHENSIVE SYSTEM OF BEST MANAGEMENT PRACTICES REQUIRED BY THE GEORGIA WATER QUALITY CONTROL ACT AND THE DOCUMENT 'MANUAL FOR EROSION AND SEDIMENT CONTROL IN GEORGIA', PUBLISHED BY THE STATE SOIL AND WATER CONSERVATION COMMISSION AS OF JANUARY OF THE YEAR IN WHICH THE LAND DISTURBING ACTIVITY WAS PERMITTED, PROVIDES FOR THE SAMPLING OF THE RECEIVING WATER(S) OR THE SAMPLING OF THE STORM WATER OUTFALLS AND THE DESIGNED SYSTEM OF BEST MANAGEMENT PRACTICES AND SAMPLING METHODS IS EXPECTED TO MEET THE REQUIREMENTS CONTAINED IN THE GENERAL NPDES PERMIT NO. GAR-1000-(1,2 OR 3).
7. "I CERTIFY UNDER PENALTY OF LAW THAT THIS PLAN WAS PREPARED AFTER A SITE VISIT TO THE LOCATIONS DESCRIBED HEREIN BY MYSELF OR MY AUTHORIZED AGENT, UNDER MY DIRECT SUPERVISION".
8. INSPECTIONS BY QUALIFIED PERSONNEL PROVIDED BY THE PRIMARY PERMITTEE AND ASSOCIATED RECORDS SHALL BE KEPT ON SITE IN COMPLIANCE WITH GAR-1000-(1,2 OR 3).

PROJECT NARRATIVE:

THE PROPOSED DEVELOPMENT IS LOCATED WITHIN AN INCORPORATED AREA OF DAWSON COUNTY, LOCATED ON HIGHWAY 53, BETWEEN LUMPKIN CAMPGROUND RD AND HOSPITALITY HWY. THE CURRENT USE IS A VACANT SITE WITH MINIMAL VEGETATION ON A 0.50 ACRE LOT. AN AUTO-REPAIR COMMERCIAL BUILDING WITH UTILITY, PARKING AND STORMWATER SYSTEM ON THIS VACANT LOT. EROSION CONTROL MEASURES SHALL BE PER THE GEORGIA SOIL AND WATER CONSERVATION COMMISSION MANUAL. NO CRITICAL AREAS ON SITE.

VICINITY MAP

1" = 1000'

EROSION CONTROL LEGEND

- SF — SF — SF — SILT FENCE
- TP — TP — TP — TREE PROTECTION FENCE
- LD — LD — LD — LIMITS OF DISTURBANCE
- CONSTRUCTION ENTRANCE/EXIT
- INLET PROTECTION

EROSION CONTROL NOTES (FOR LAND DISTURBANCE UNDER 1.0 ACRE):

1. EROSION CONTROL PRACTICES MUST COMPLY WITH THE MINIMUM BEST MANAGEMENT PRACTICES FOR EROSION CONTROL AND SHALL COMPLY WITH THE STANDARDS/SPECIFICATIONS IN THE "MANUAL FOR EROSION AND SEDIMENT CONTROL IN GEORGIA".
2. ADDITIONAL EROSION CONTROL MEASURES MAY BE REQUIRED BY SITE CONDITIONS OR LOCAL ISSUING AUTHORITY INSPECTORS.
3. EROSION AND SEDIMENT CONTROL MEASURES SHALL BE INSTALLED AND INSPECTED PRIOR TO ANY GRADING ON SITE TAKES PLACE.
4. SEDIMENT AND EROSION CONTROL DEVICES MUST BE CHECKED AFTER EACH STORM EVENT. EACH DEVICE MUST BE CLEANED, MAINTAINED OR REPLACED IF SEDIMENT ACCUMULATION HAS REACHED ONE HALF THE CAPACITY OF THE DEVICE. ADDITIONAL DEVICES MUST BE INSTALLED IF NEW CHANNELS HAVE DEVELOPED.
5. MULCH, TEMPORARY VEGETATION, PERMANENT (PERENNIAL) VEGETATION SHALL BE INSTALLED ON ALL EXPOSED AREAS WITHIN SEVEN (7) DAYS OF DISTURBANCE.
6. TEMPORARY VEGETATION (Ds1 OR Ds2) MUST BE ESTABLISHED ON ALL DISTURBED AREAS LEFT IDLE FOR SEVEN (7) DAYS AND NOT TO FINAL GRADE.
7. PERMANENT VEGETATION (Ds3 OR Ds4) MUST BE ESTABLISHED ON ALL AREAS REACHING FINAL GRADE IMMEDIATELY UPON COMPLETION.
8. CONTRACTOR IS RESPONSIBLE FOR ESTABLISHING EROSION AND SEDIMENTATION CONTROL MEASURES AT THE BEGINNING OF THE PROJECT AND MAINTAINING THEM THROUGHOUT THE DURATION OF THE PROJECT. THE EROSION CONTROL MEASURES CAN ONLY BE REMOVED ONCE PERMANENT STABILIZATION IS ATTAINED THROUGHOUT THE ENTIRE PROJECT AREA.
9. CONTRACTOR IS ALSO RESPONSIBLE FOR ENSURING THAT NO SEDIMENT GET INTO THE EXISTING UNDERGROUND STORMWATER DETENTION SYSTEM OR OTHER EXISTING UTILITY LINES.
10. THE CONSTRUCTION EXIT MUST BE MAINTAINED IN A CONDITION WHICH WILL PREVENT TRACKING OF MUD OR OTHER DEBRIS INTO THE PUBLIC RIGHT-OF-WAY.
11. IF CONSTRUCTION OF THIS DEVELOPMENT IS DELAYED FOR ANY REASON, DISTURBED AREAS MUST BE SEEDD UNTIL THE TIME THAT CONSTRUCTION RESUMES.
12. REFER TO SHEET L5.00 FOR VEGETATIVE PLAN.

FEMA FLOODPLAIN NOTE:

1. THE SUBJECT PARCEL IS NOT LOCATED WITHIN A SPECIAL FLOOD HAZARD ZONE. IT IS LOCATED IN ZONE "X" AS DEFINED BY FIRM PANEL NUMBER 13085C0225C DATED ON 04/04/2018.

24 HR CONTACT:

COLLEEN THELEN
CONSTRUCTION & ASSET MANAGER
N3 REAL ESTATE
TEL: 609.651.9327
EMAIL: CTHELEN@N3REALESTATE.COM



Know what's below.
Call before you dig.

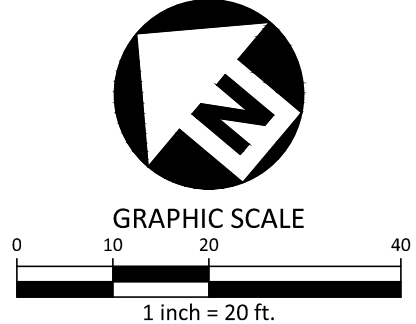

ALL CONSTRUCTION SHALL BE IN ACCORDANCE WITH THE CURRENT DAWSON COUNTY ENGINEERING DESIGN AND CONSTRUCTION STANDARDS

PRELIMINARY DRAWING - NOT RELEASED FOR CONSTRUCTION



McADAMS

The John R. McAdams Company, Inc.
2905 Meridian Parkway
Durham, NC 27713

phone 919. 361. 5000
fax 919. 361. 2269
GA license number: PEF007872

www.mcadamsco.com

CLIENT

N3 REAL ESTATE
1240 N KIMBALL AVE
SOUTHLAKE, TX
PHONE: 817.348.8748



STRICKLAND BROTHERS OIL
CHANGE - DAWSONVILLE
SITE PLAN SUBMITTAL
HIGHWAY 53, NORTHWEST OF ITS
INTERSECTION WITH CENTER LANE
DAWSONVILLE, GA 30534

GSWCC CERTIFICATION #: 94146



REVISIONS

NO.	DATE	REVISION DESCRIPTION
1	-	-
2	-	-
3	-	-
4	-	-
5	-	-
6	-	-

PLAN INFORMATION

PROJECT NO.	NTR21002
FILENAME	NTR21002-ESPC
CHECKED BY	LAM
DRAWN BY	AP
SCALE	1" = 20'
DATE	12.15.2021

SHEET

EROSION CONTROL
PLAN

C6.00